

Apogeo

STUDIO TECNICO ASSOCIATO

Comune di Certaldo

Allegato 3/19 alla deliberazione

n. 75/CC del 06/07/06

Oggetto: Piano di Recupero Urbanistico
di edifici ed aree artigianali

Località: Via Romana - Zona 4B27

I Richiedenti:  Paolo Pettini e Lucia Pettini

Il Progettista: Dott. Arch. Barbara Bertini

Il Collaboratore: Geom. Fabio Leti



Documentazione Fotografica

f1

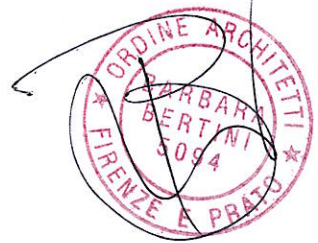
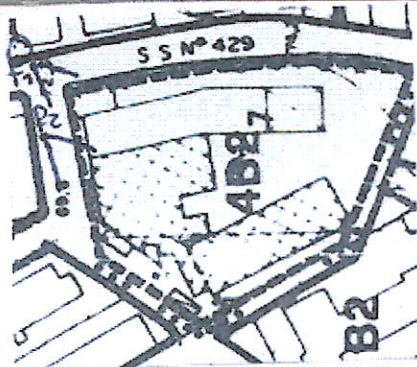

f2



74

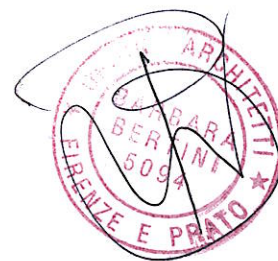
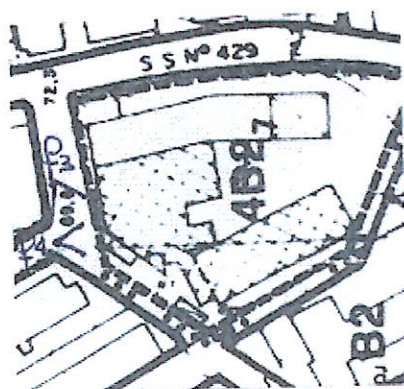

P3





F5

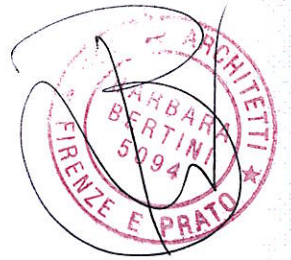
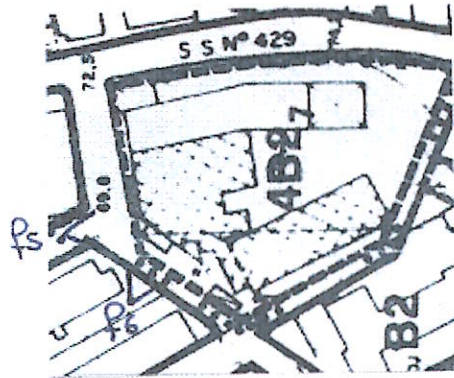

F6



f7

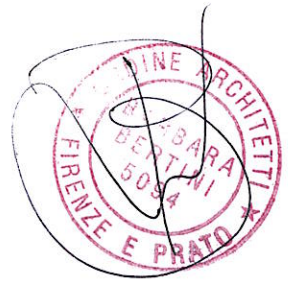
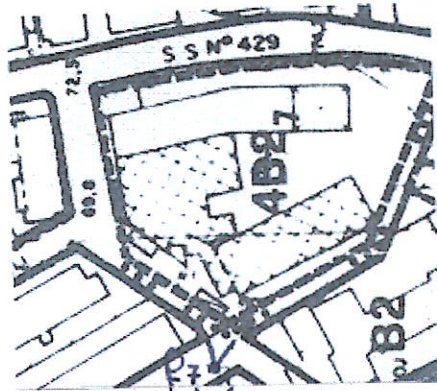

f8



f9

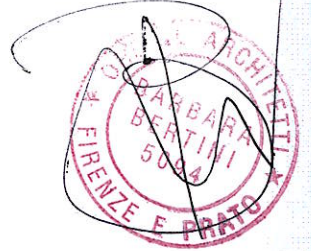
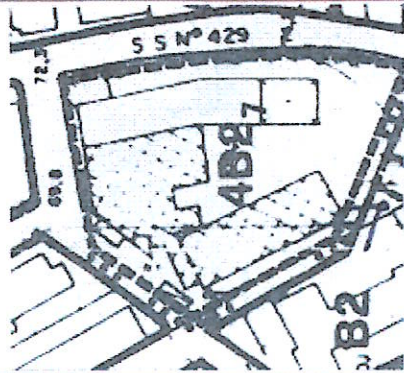

f10

F11

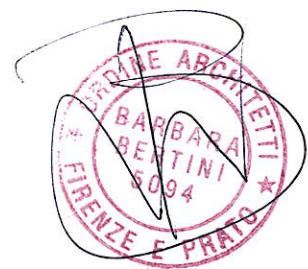
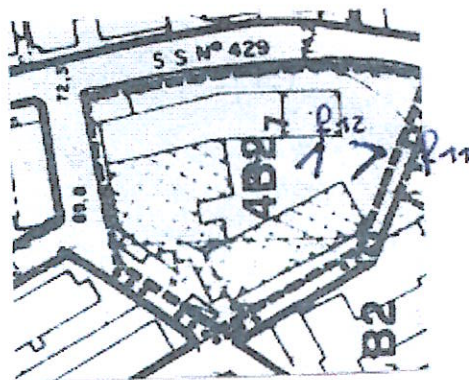

F12



F13

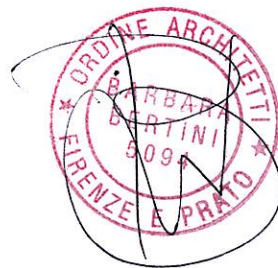
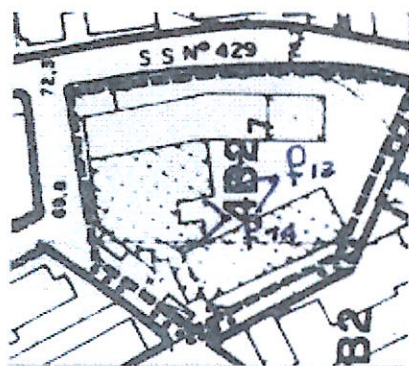

F14



f. 15.

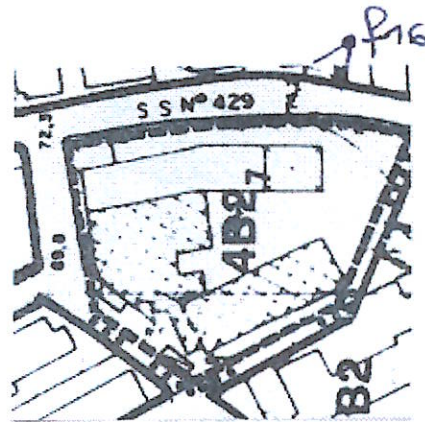

f. 15



f. 16.



F 17

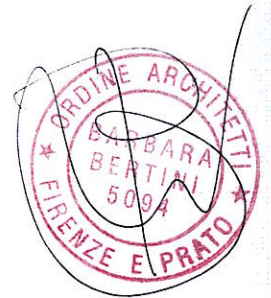
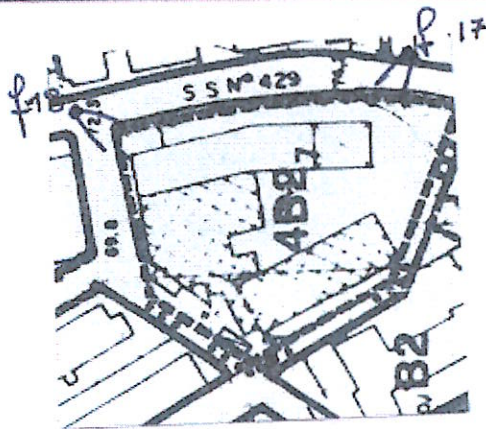

F 18

