

13	14975	TOTALE	75044
14	13250		
B <sub>2</sub>	15	14413	14413
			<b>B<sub>2</sub> MO 171289</b>
B <sub>3</sub>	1	2000	
	2	9680	
	3	11832	
	4	1330	
	5	4180	
	6	1925	
	7	2750	
	8	2750	
	9	2090	
	10	4390	
	11	5300	
	12	4875	
	13	4890	
	14	2100	
		TOTALE	61372

B <sub>2</sub>	15	14280	14280
B <sub>3</sub>	16	2927	
	17	8438	
	18	1350	
	19	2000	
	20	3920	
	21	3500	
	22	3800	
	23	3062	
	24	6250	
	25	3488	
	26	3300	
	27	4600	
		TOTALE	47635
			<b>B<sub>3</sub> MO 123287</b>

B <sub>3</sub>	1	10312	
	2	6198	
	3	9826	
	4	2022	
	5	9262	
	6	7650	
	7	15900	
	8	15315	
	9	800	
	10	1800	
	11	7192	
	12	8357	
	13	1200	
	14	5090	
	15	6510	
	16	12718	
	17	2040	
	18	3850	
	19	1540	
	20	14450	
	21	4925	
	22	1200	
	23	1889	
	24	2200	
	25	1400	
		TOTALE	154417

B <sub>3</sub>	26	8438	
	27	5372	
	28	5037	
	29	6175	
		TOTALE	25022

B <sub>3</sub>	30	4013	
	31	7087	
	32	29875	
		TOTALE	40875
			<b>B<sub>4</sub> MO 220414</b>

B <sub>3</sub>	1	7787	
	2	23945	
	3	19198	
		TOTALE	50930

B <sub>3</sub>	4	5287	
	5	2125	
	6	1750	
	7	8319	
		TOTALE	17481
			<b>B<sub>5</sub> MO 68411</b>
			<b>MO 644205</b>

C <sub>1</sub>	1	76380	76380
C <sub>2</sub>	1	39770	39770
C <sub>2</sub>	1	13450	13450
C <sub>2</sub>	1	53500	
	2	40685	
	3	55488	
		TOTALE	148673

C <sub>5</sub>	1	12938	
	2	27250	
	3	2975	
	4	20450	
	5	4873	
	6	1350	
	7	14175	
	8	11538	
		TOTALE	99554
			<b>MO 378827</b>

167	1	54489	
	2	12675	
		TOTALE	68164
			<b>MO 68164</b>

D	1	32385	
	2	154875	
	3	122600	
		TOTALE	374186

D	5	27224	27224
---	---	-------	-------

D	6	76637	76637
---	---	-------	-------

D	7	54550	54550
	8	126815	
	9	47775	
		TOTALE	229140

D	10	18313	
	11	3450	
		TOTALE	21763
			<b>MO 783500</b>



MO 425776

SP	14	11015	
SP	15	3588	
SP	16	70417	
SP	17	21172	
SP	18	3250	
SP	19	4875	
SP	20	9900	
SP	21	10537	
SP	22	5825	
SP	23	110857	
SP	24	109059	
SP	25	24250	
SP	26	6994	
SP	27	3163	
SP	28	17000	
SP	29	3000	
		TOTALE	744833

AT	①	12500	<b>MO 12500</b>
	2	10875	
	3	19912	
	4	7738	
	5	8850	<b>MO 63800</b>
	6	8950	
	7	8900	
	⑥	3825	<b>MO 3825</b>
		TOTALE	80125

SC	1	30712	
	2	11385	
	3	9125	
	4	1984	
	5	3740	
	6	7110	
	7	3225	
	8	340	
	9	32850	
		TOTALE	100571

(P)	①	200	
	②	4500	<b>MO 6650</b>
	③	1950	
		TOTALE	6650

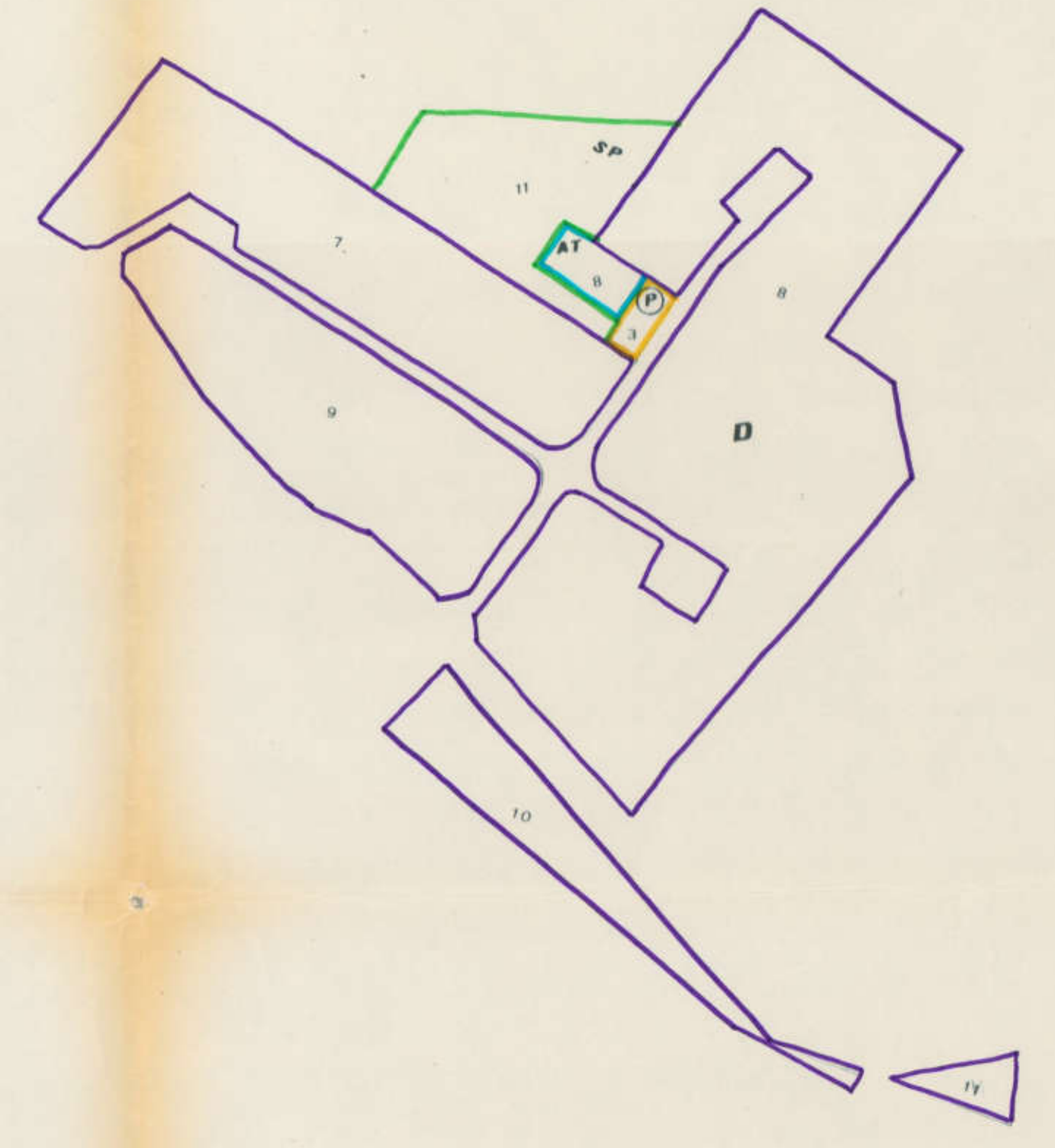

1:5000